

- 1 Remove the round cardboard pad from inside the supplied template .

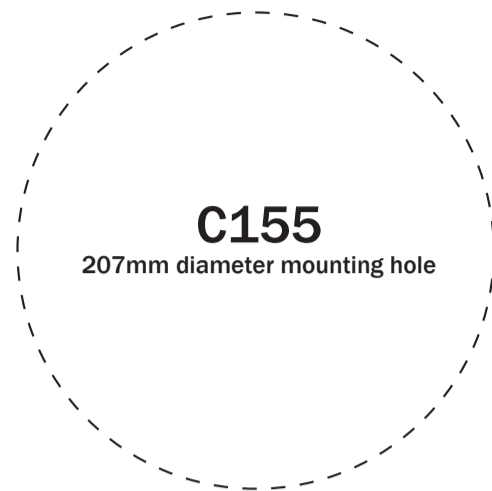

- 2 Use the template to mark the position for the mounting hole at the selected location.

Before cutting ceiling speaker holes, it is suggested that the area is tested for clearance by making an L-shaped probe from strong wire (see illustration below), drilling a small hole in the target area, inserting the probe and slowly turning. Any obstructions will be immediately obvious, and the target area can be moved to a more suitable position.

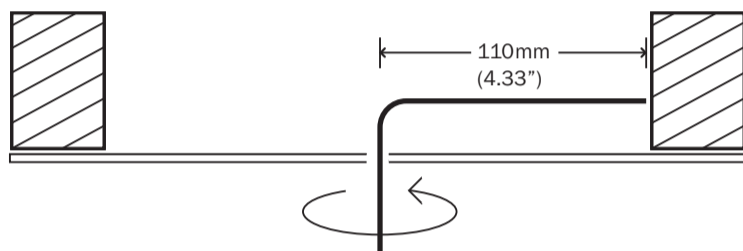

- 3 Cut the mounting hole with a drywall or keyhole saw.

Be sure the mounting surface is between 10 and 30mm(0.39 - 1.18") thick, and that there is at least 80mm(3.15") of clearance behind the mounting surface.

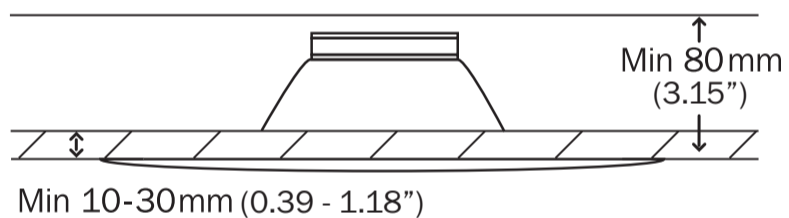

Mounting the C155

Before mounting, ensure that the four fixing screws are slackened off so that the red mounting dog-legs can move freely. Move each red dog-leg foot to the LEFT into it's holding slot, and then insert the speaker into the mounting hole. Using a cross-head screwdriver, slowly turn each fixing screw clockwise. This will move the mounting dog-legs out of their slots. Tighten each fixing screw until the mounting dog-legs grip the ceiling.

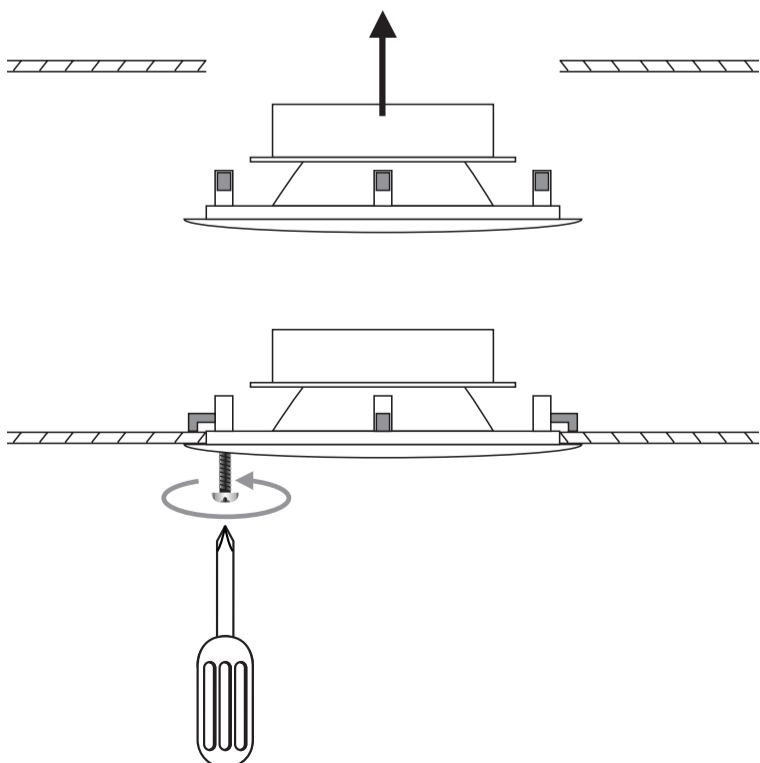

Connecting the C155

Do not compromise the performance of your system by using inferior quality speaker cables. We recommend that high quality cables of 16 gauge or higher be used. Your professional dealer will give you good advice. Always unplug all A.C. powered components before making any loudspeaker or component connections. This will avoid the risk of electric shock or damage to your equipment.

Follow these steps to connect the speaker to your amplification system:

- 1 Route the speaker cable from your amplification system to the speakers.
 - Avoid routing the speaker cable near electrical wires
 - Do not nail or staple the cable
- 2 Separate about 100mm of speaker cable at each end.

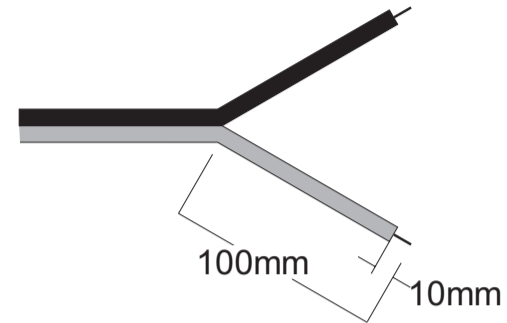

- 3 Using a wire stripper, remove about 10mm of insulation from both ends of each conductor, and then twist the strands of each conductor .
- 4 Observing polarity is of the utmost importance while connecting your speakers. Ensure that the red (+) terminals on your amplification system are connected to the red (+) on the speakers, and black (-) on your amplification system to black (-) on your speakers .

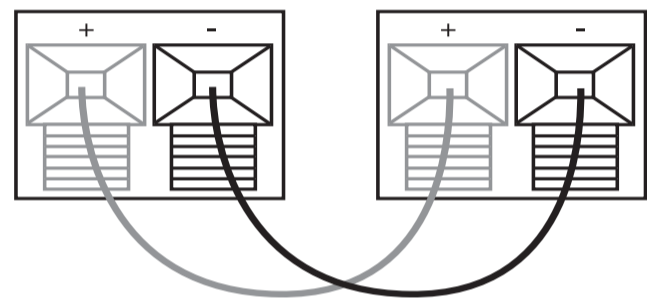

The speaker cable is coded with a bead or stripe down one lead's insulation, or has differently coloured wires. Press the spring-loaded red or black tab back to reveal the connecting hole. Insert the stripped end of the speaker wire, then release the tab.

- 5 If your speakers are wired incorrectly they will be out of phase and sound hollow and indistinct, with a weak bass. Re-check your connections for correct polarity and reverse the connections if necessary.

PAINTING THE FRAME AND GRILLE

Remove grille by inserting a small hook or similar small implement into one of the grille openings, then pulling on the grille. Fit the clear plastic painting mask provided when painting the speaker surround to avoid getting paint getting on the speaker cone.

